



1600

MARKET STREET

A BOLD NEW CHAPTER

MORE THAN AN OFFICE. IT'S A **VIBE.**

A Philadelphia classic has entered a bold new chapter. With a strikingly redesigned lobby, prominent new signage, and a buzzing café energizing the ground floor, 1600 Market has been transformed for how today's companies work and connect.

The building's full-scale reinvention in the heart of City Center delivers a blend of inspiration, functionality, and a uniquely modern experience—exceeding the expectations of today's workforce.

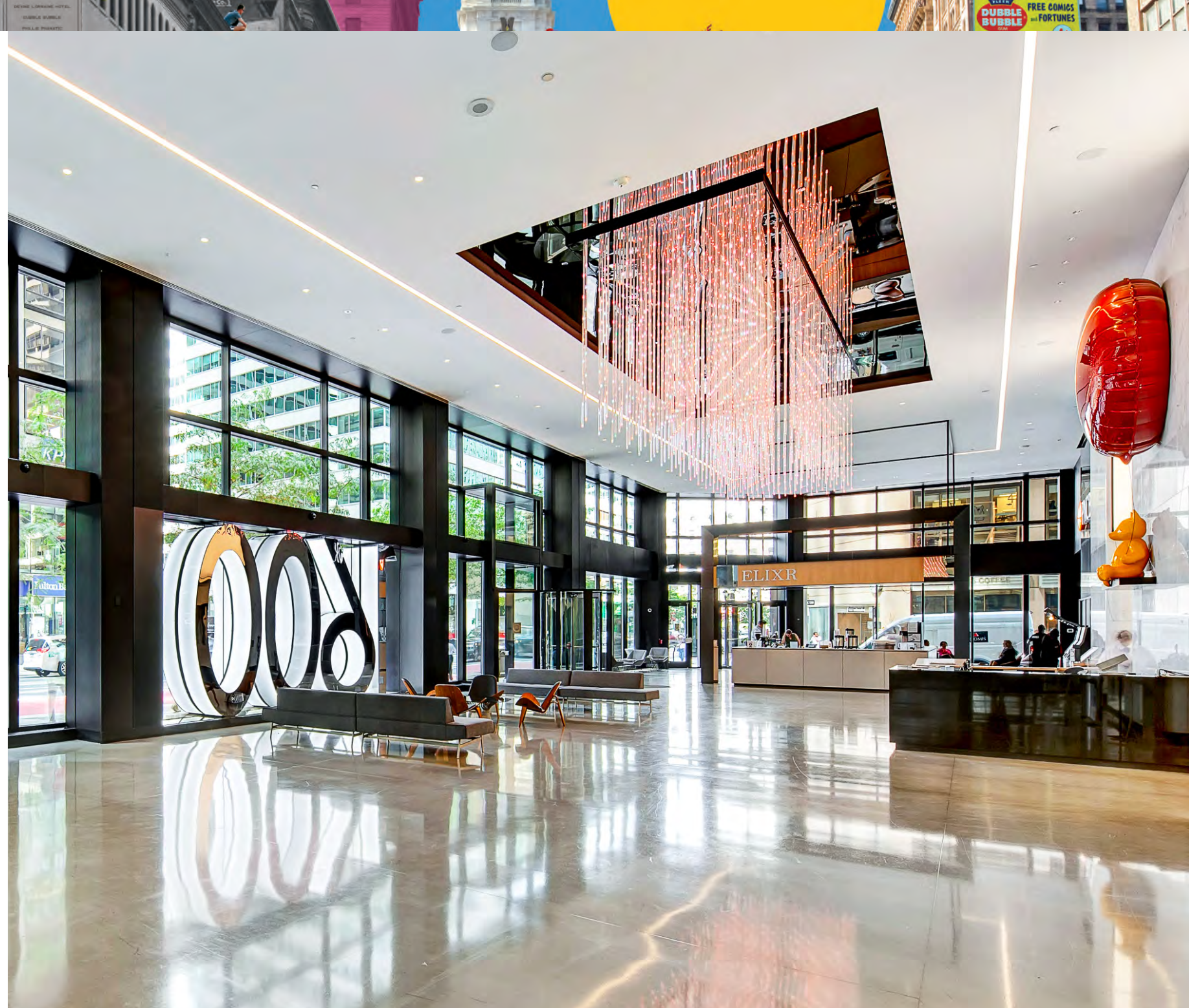

PURPOSEFUL AMENITIES WITH A PHILLY **TWIST**

Designed exclusively for building tenants, this is one of the most creative and functional amenity spaces in Philadelphia.

AREP has redefined the workday with a bold, unexpected environment that inspires focus, fosters connection, and breaks the mold of the traditional office tower.





YOUR WORKOUT. YOUR SCHEDULE.

A 5,000 SF double-height fitness center right inside the building—flooded with natural light and outfitted with top-tier equipment.

Spa-inspired locker rooms, expansive workout areas, and a bright, energizing atmosphere make wellness a seamless part of the workday.

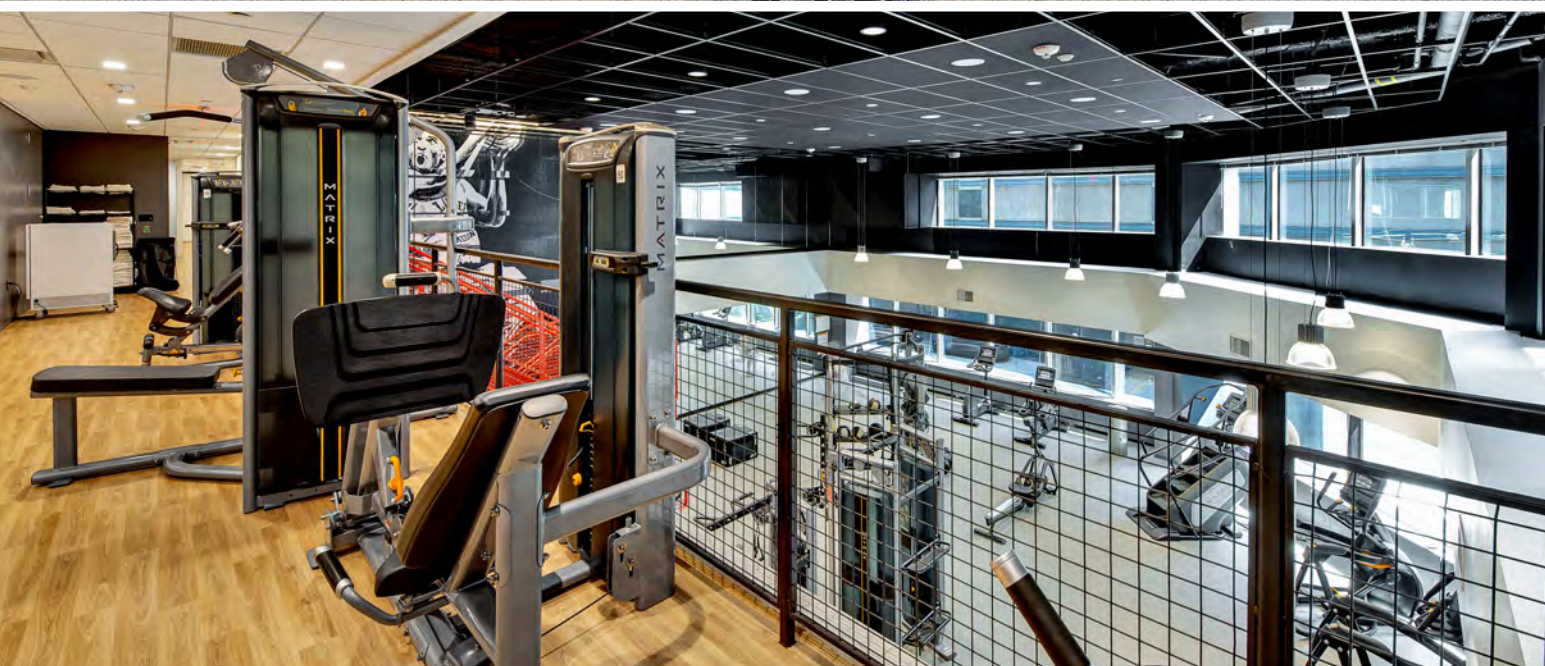

FUEL YOUR FLOW WITH **ELIXR** COFFEE ROASTERS

An award-winning local favorite delivers an exceptional sit-and-stay or grab-and-go café experience for tenants and their guests - right from the heart of the building's activated lobby.



AVAILABILITIES

Flexible workspaces available ranging from small suites to full floors with large block opportunities.

38	38th Floor (Entire Floor) - 16,351 SF		
37		37th Floor - 6,968 SF	
35	35th Floor (Entire Floor) - 22,840 SF		
28	28th Floor (Entire Floor) - 23,021 SF		
26	Suite 2650 - 4,731 SF	Suite 2620 - 3,431 SF	
20		Suite 2020 - 5,945 SF	
18	Suite 1810 - 1,981 SF		Suite 1800 - 12,278 SF
17	Suite 1720 - 2,482 SF	Suite 1710 - 1,612 SF	
16	Suite 1650 - 3,987 SF	Suite 1616 - 7,332 SF	
15	15th Floor (Spec Suites) - 22,069 SF		
14	Suite 1416 - 4,813 SF		
13		Suite 1300 - 11,726 SF	
12		Suite 1210 - 10,427 SF	
5	Suite 510 - 4,118 SF	Suite 505 - 1,828 SF	Suite 550 - 1,293 SF
2	Tenants Only Conference / Amenity Center		
1	Lobby Quick-Service Café Patio		

Available Suites

Leased



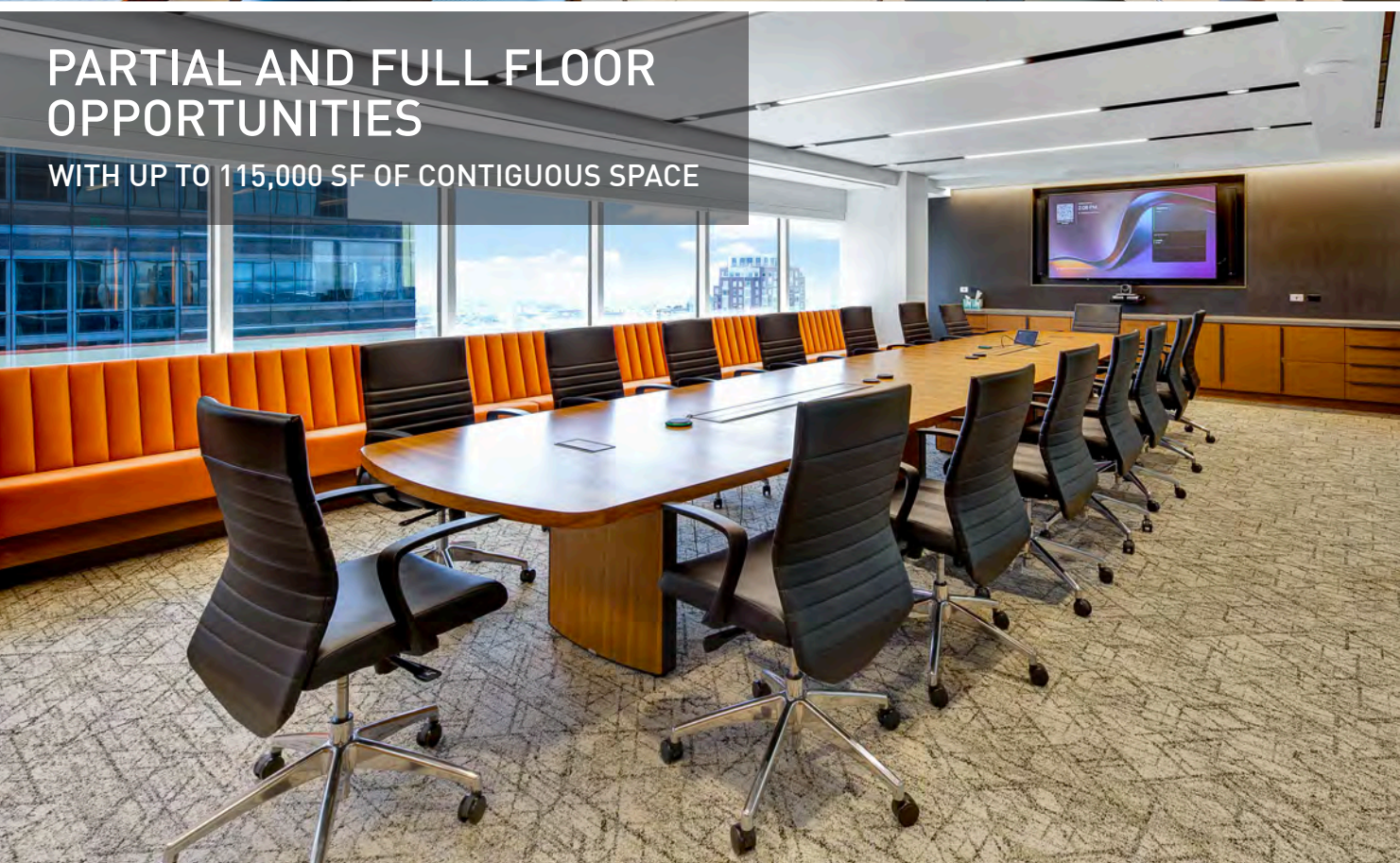

PARTIAL AND FULL FLOOR
OPPORTUNITIES
WITH UP TO 115,000 SF OF CONTIGUOUS SPACE



TYPICAL FULL-FLOOR

FLOOR 29 | 23,021 SF

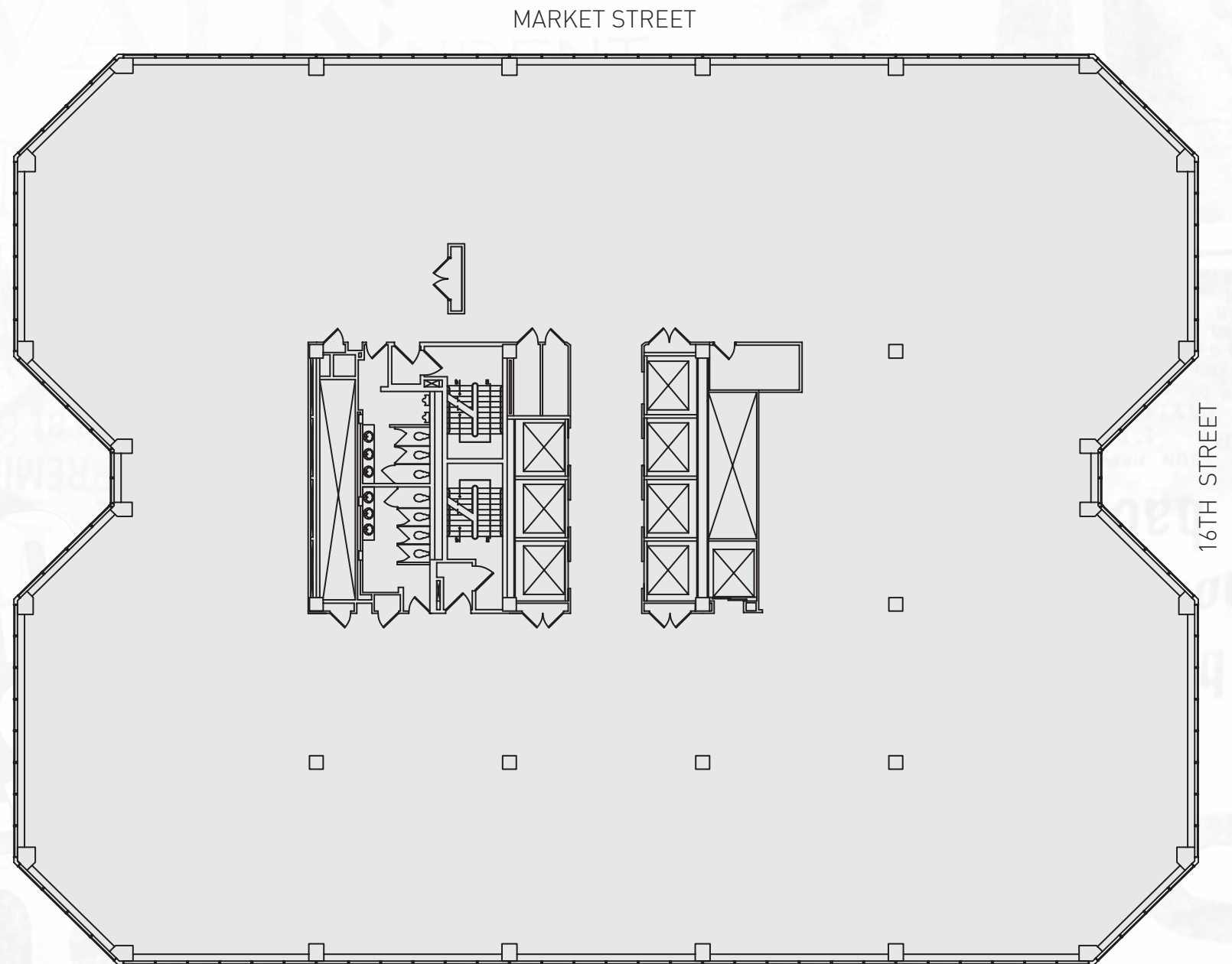



 100 Walking score  80+ Restaurants  80+ Retailers  10+ Hotels **ALL WITHIN A TWO BLOCK RADIUS**

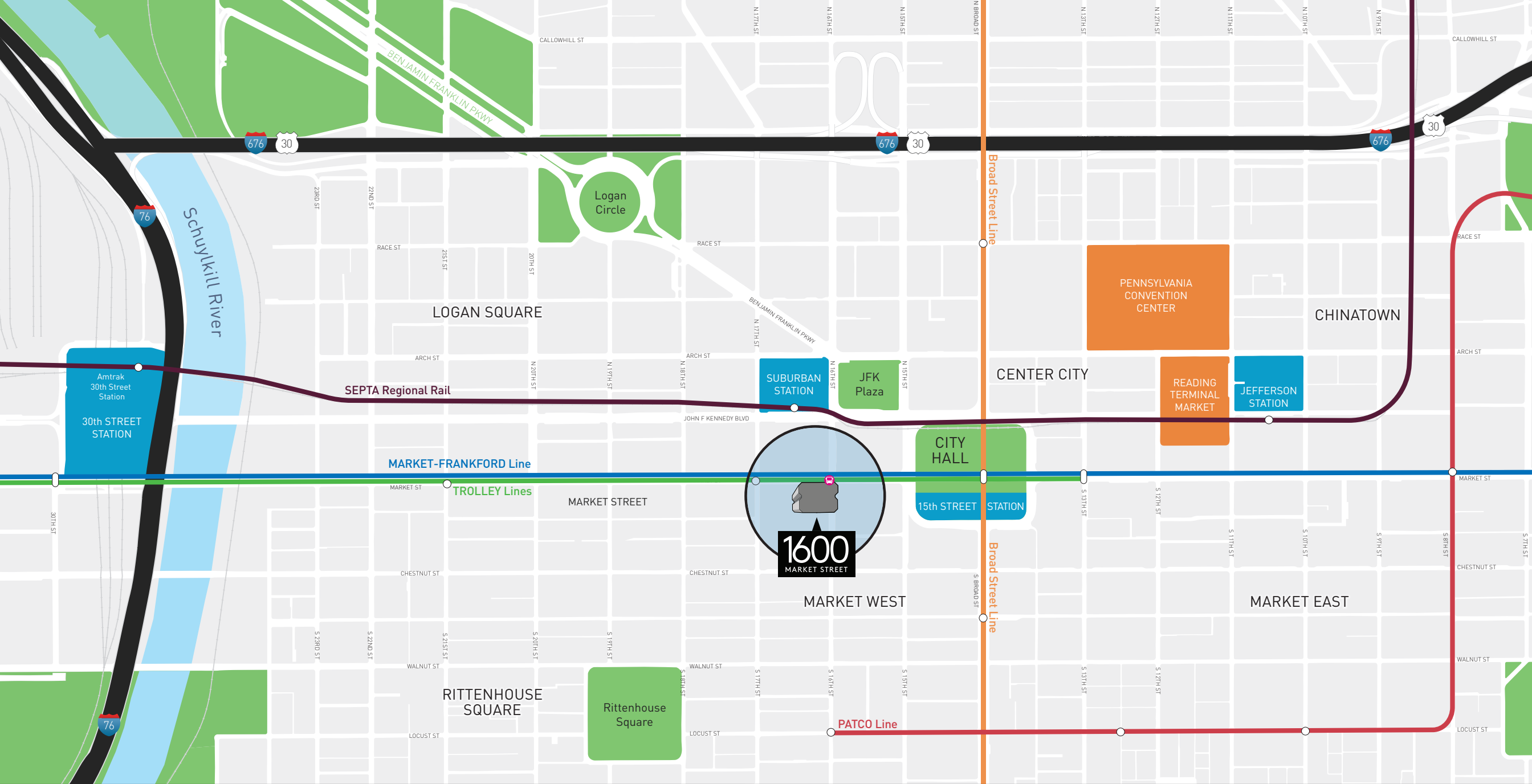

TRANSIT



02

Blocks from Philadelphia's Suburban Station, the City's Central Commuter Hub



01

Block from City Hall, Broad Street Line and Frankford Elevated Line

SWEEPING VIEWS
of Philadelphia's iconic cityscapes
& landmarks, in every direction.





AREPx provides AREP's tenants with a seamless and curated experience specific to each individual property, delivering hyper local content, amenities, programming, and digital access throughout the property. Through AREPx, tenants will be able to enter the building, book conference space, provide guest access, engage with their property team, get access to exclusive AREPx Perks, order food and stay up to date on community and building events through notifications and news that's relevant to them.



SCAN ME

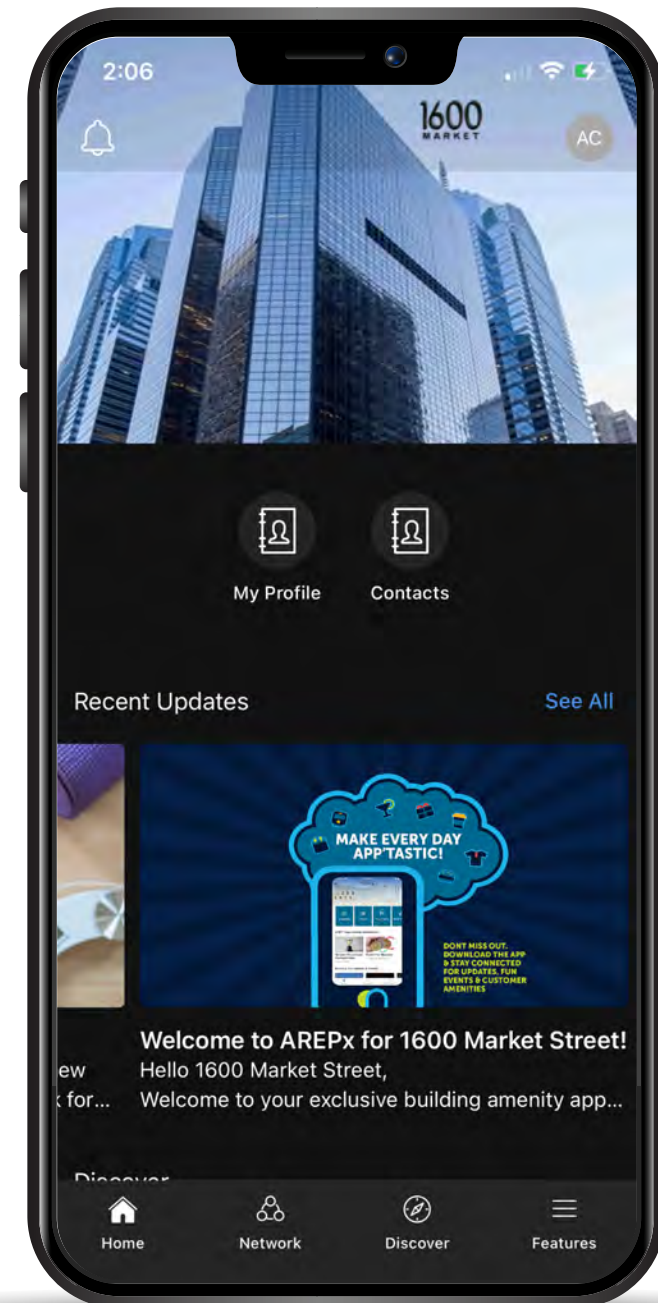
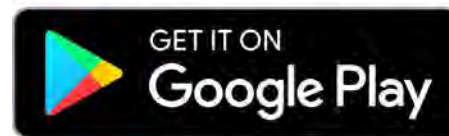



Inventa Towers Silver Spring, MD



161 Washington St. Conshohocken, PA



Rosslyn City Center Rosslyn, VA

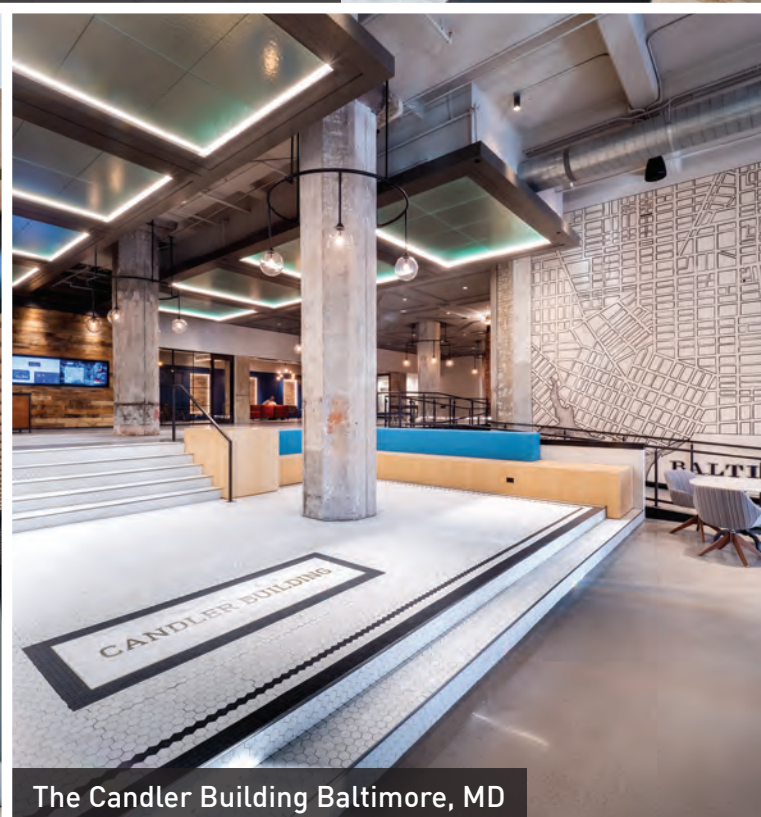

The Candler Building Baltimore, MD

BEYOND THE EXPECTED

WE ARE CURATORS OF PLACE

AREP has redeveloped other impressive properties with inspired environments and experiences to create the places where people prosper. **Our success begins with yours.**

americanrepartners.com

RIGHT ON MARKET. CENTERED IN THE CITY.



Jones Lang LaSalle Brokerage, Inc.

1700 Market Street, Suite 2400
Philadelphia, PA 19103
215.988.5500

Mitch Marcus

Senior Managing Director
215.988.5514
mitch.marcus@jll.com

Alex Breitmayer

Managing Director
215.988.1813
alex.breitmayer@jll.com

Jake Marcus

Associate
856.905.0454
jake.marcus@jll.com



1600market.com